

VDRG® FMDV PAN Ag Rapid Kit

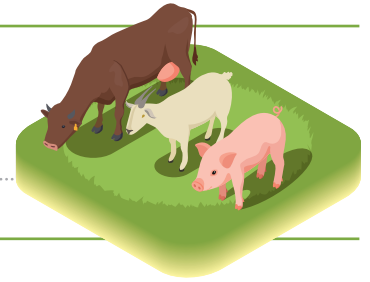

General Description

The test kit, the diagnostic reagent can detect FMDV serotype antigen quickly and simply within 15 minutes after dropping the samples.

Introduction

- + **Intended use** : Detection of all seven FMDV serotype antigens
- + **Principle** : Immunochromatographic assay
- + **Specimen** : Fluids from unruptured vesicles/apthae and vesicular epithelium from ruptured lesions
- + **Component** - FMDV PAN Ag Rapid Test device
 - Sample Dilution Buffer
 - Test Tube
 - Swab
 - Dropper



Features

- + Clinical Sensitivity
 - 1) FMD type O 88.2%(n=60/68) vs PCR
 - 2) type A 100%(n=70), Asia 100%(n=62), SAT 1 100%(n=20), SAT 2 100%(n=20), SAT 3 100%(n=20), C 100%(n=20), in spiking samples with virus (titer : 1.0x10⁵TCID₅₀/ml or higher)
- + Clinical Specificity
 - 1) normal cattle 100%(n=92), normal pigs 100%(n=400)

Sample preparation

A. Sample collection

1. Collection of fluid from intact vesicle : draw vesicular fluid with syringe.
2. Collection of fluid from ruptured vesicles : Soak vesicular fluid using a cotton swab.
3. Tissue sampling from ruptured lesions.
 - ① Follow the instruction manual in VDRG® Tissue Sample Extraction kit (CAT.NO. EXT-TIS-11, not provided).
 - ② Collect 0.2g of fresh and friable epithelium (size of little finger nail) from surface or margin of vesicles or other tissues of interest.
4. Cultured virus: collect virus culture media using micropipette.

B. Sample processing

1. Syringe-collected fresh vesicular fluid
 - ① Add 4 drops (approximately 100µl) of Sample Dilution Buffer to the test tube
 - ② Add 100uL of syringe-collected vesicular fluid to the test tube and mix gently.
2. Swab-collected fluid

- ① Add 10 drops (approximately 250µl) of Sample Dilution Buffer to the test tube.
- ② Soak the swab in the fluid, mix by swirling and extract the vesicular lesion fluid by pressing the cotton bud against the tube wall.
- ③ Remove the swab from the test tube after extraction.
3. Tissue-extracted fluid
 - ① Follow the instruction manual of VDRG® Tissue Sample Extraction kit (Cat. No. EXK-FMD-11, not provided).
 - ② Add 40 drops (1ml) of Sample Dilution Buffer to the extraction vial
 - ③ Add tissue sample to the extraction vial
 - ④ Cut the tissue with scissors and grind using pestle and sand included in the kit.
 - ⑤ Leave the homogenate for 2-3 minutes to settle down tissue fraction.
4. Virus culture media
 - ① Add 100uL of Sample Dilution Buffer to the test tube, Eppendorf tube or microplates.
 - ② Add 100uL of virus culture media to the test tube and mix by several times of swirling.

Test procedure

- 1 Slowly add 4 drops (100uL) of the processed sample solution to position "S" on the test device using a dropper (provided) or micropipette (not provided).

- 2 Read test results after **15 minutes**.

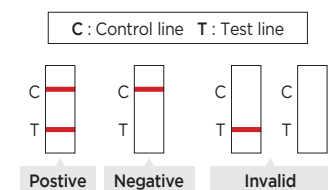
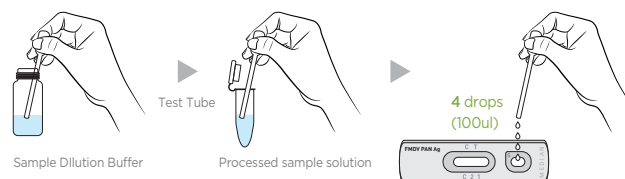

Order Information

Cat No.	Product Name	Quantity
PM-FMD-15	VDRG® FMDV PAN Ag Rapid Kit	10 Tests/Box